

6 BUILDINGS. 3,000,000 SQUARE FEET.

**UNLIMITED ACCESS.**



# 20 EAST

## TRINITY POINTE

**MATT DORNAK, SIOR** | 214.267.0461 | [mdornak@streamrealty.com](mailto:mdornak@streamrealty.com)  
**RIDLEY CULP** | 214.560.2422 | [ridley.culp@streamrealty.com](mailto:ridley.culp@streamrealty.com)

OWNED & DEVELOPED BY:

  
**STREAM**



## Phase I

3

buildings

1.8M

square feet

192

acres

## Phase II (Planned)

3

buildings

1.6M

square feet

91

acres

# PROPERTY HIGHLIGHTS

- Building expandability available
- Build-to-suit opportunities
- Abundant trailer positions with ability to expand
- Ability to expand car parks
- Interstate 20 visibility
- Ability to secure premises and truck courts
- Ability to install guard shack
- Triple Freeport tax exempt
- Build-ready infrastructure and utilities
- Pro-business city with ability to provide tax incentives

## Building 1

<b>Building Size</b>	293,548 SF
<b>Dimensions</b>	310' x 950'
<b>Clear Height</b>	36'
<b>Office</b>	Build-to-Suit
<b>Dock Doors</b>	44 - 9' x 10'
<b>Drive-In Ramps</b>	2 - 12' x 14'
<b>Column Spacing</b>	54' x 50'
<b>Staging Bay</b>	60'
<b>Truck Court Depth</b>	185'

<b>Trailer Parks</b>	57
<b>Car Parks</b>	557
<b>Sprinkler</b>	ESFR
<b>Slab</b>	7" Reinforced Concrete, 4,000 PSW w/ Full Vapor Barrier
<b>Power</b>	3 Phase - Finish to Suit
<b>Roof &amp; Insulation</b>	TPO with R9
<b>Security</b>	Ability to Fully Secure with Fence and Guard Shack
<b>Spec Finish Out</b>	White Box, Painted Columns, LED Wall Packs, Pole Lights

## Building 2

<b>Building Size</b>	1,009,530 SF
<b>Dimensions</b>	620' x 1,629'
<b>Clear Height</b>	40'
<b>Office</b>	Build-to-Suit
<b>Dock Doors</b>	154 - 9' x 10'
<b>Drive-In Ramps</b>	4 - 12' x 14'
<b>Column Spacing</b>	56' x 50'
<b>Staging Bay</b>	60'
<b>Truck Court Depth</b>	185'

<b>Trailer Parks</b>	196
<b>Car Parks</b>	1,074
<b>Sprinkler</b>	ESFR
<b>Slab</b>	8" Reinforced Concrete, 4,000 PSW w/ Full Vapor Barrier
<b>Power</b>	3 Phase - Finish to Suit
<b>Roof &amp; Insulation</b>	TPO with R9
<b>Security</b>	Ability to Fully Secure with Fence and Guard Shack
<b>Spec Finish Out</b>	White Box, Painted Columns, LED Wall Packs, Pole Lights

## Building 5

<b>Building Size (Expandable)</b>	483,874 SF
<b>Dimensions</b>	570' x 850'
<b>Clear Height</b>	40'
<b>Office</b>	Build-to-Suit
<b>Dock Doors</b>	74 - 9' x 10'
<b>Drive-In Ramps</b>	4 - 12' x 14'
<b>Column Spacing</b>	56' x 50'
<b>Staging Bay</b>	60'
<b>Truck Court Depth</b>	185'

<b>Trailer Parks</b>	94
<b>Car Parks</b>	330
<b>Sprinkler</b>	ESFR
<b>Slab</b>	7" Reinforced Concrete, 4,000 PSW w/ Full Vapor Barrier
<b>Power</b>	3 Phase - Finish to Suit
<b>Roof &amp; Insulation</b>	TPO with R9
<b>Security</b>	Ability to Fully Secure with Fence and Guard Shack
<b>Spec Finish Out</b>	White Box, Painted Columns, LED Wall Packs, Pole Lights



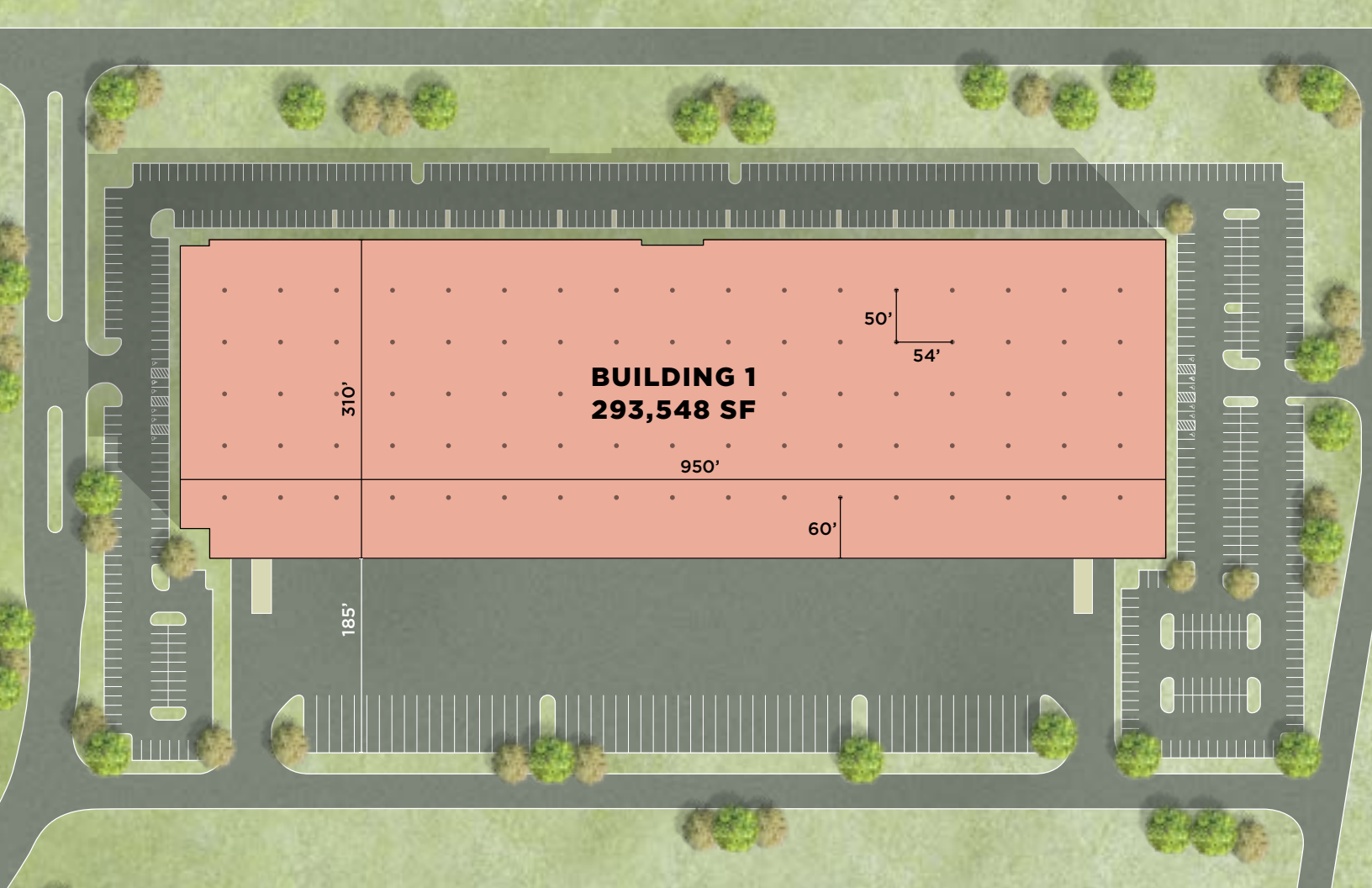

# Building 1

**293,548 SF**

size

**Build-to-Suit**

office

**310' x 950'**

dimensions

**36'**

clear height

TYP. COLUMN SPACING 54' w x 50' d

STAGING BAY 60'

TRUCK COURT DEPTH 185'

DOCK DOORS 44 (9' x 10')

DRIVE-IN RAMPS 2 (12' x 14')

TRAILER PARKS 57

CAR PARKS 557

SPRINKLER SYSTEM ESFR

SLAB 7" Reinforced Concrete, 4,000 PSW w/ Full Vapor Barrier

POWER 3 Phase - Finish to Suit

ROOF & INSULATION TPO with R9

SECURITY Ability to Fully Secure with Fence/Guard Shack

SPEC FINISH OUT White Box, Painted Columns, LED Wall Packs, Pole Lights

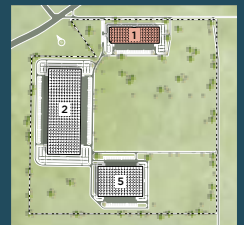

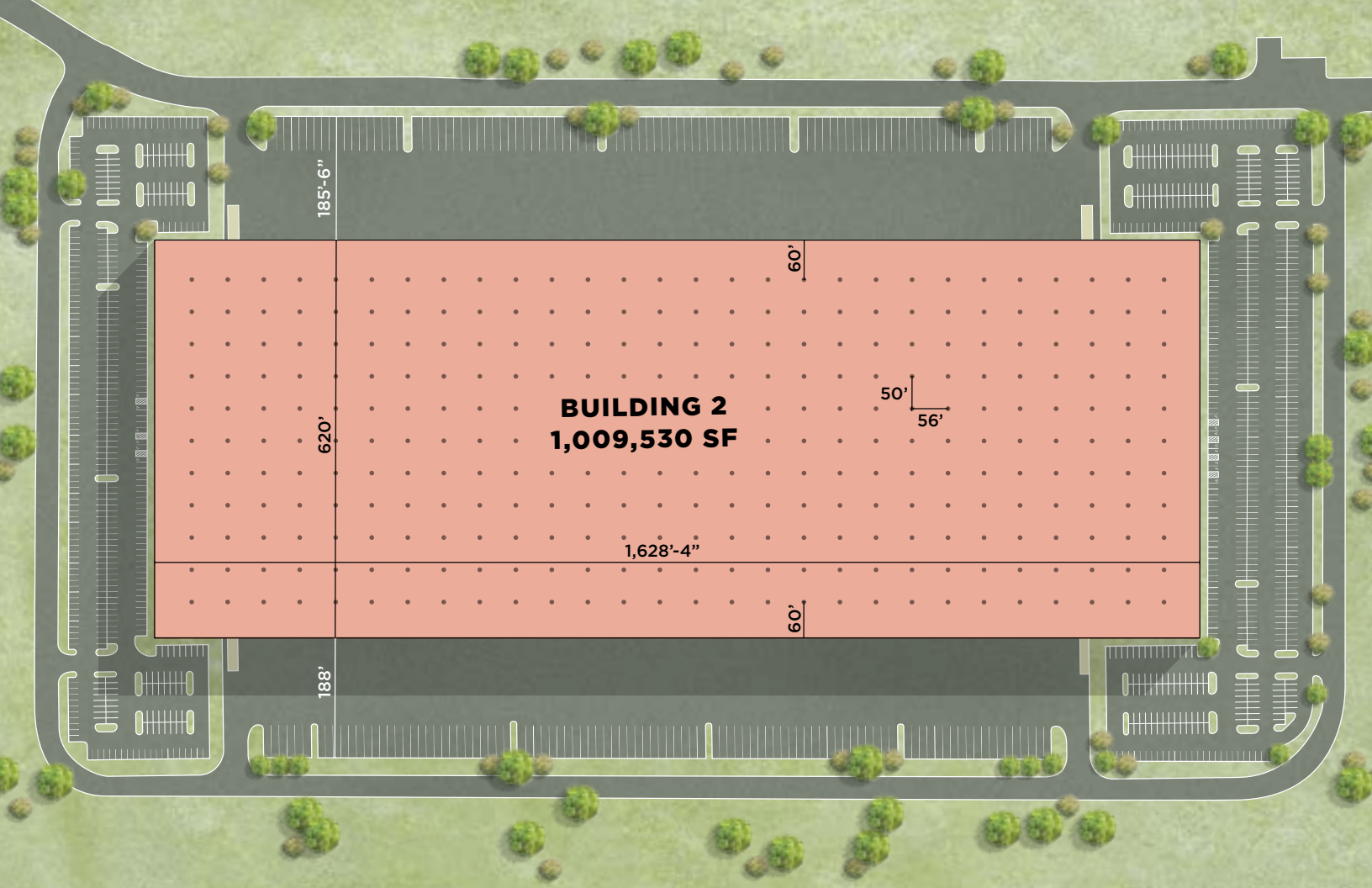

## Building 2

**1,009,530 SF**

size

**Build-to-Suit**

office

**620' x 1,629'**

dimensions

**40'**

clear height

TYP. COLUMN SPACING	56' w x 50' d
STAGING BAY	60'
TRUCK COURT DEPTH	185'
DOCK DOORS	154 (9' x 10')
DRIVE-IN RAMPS	4 (12' x 14')
TRAILER PARKS	196
CAR PARKS	1,074
SPRINKLER SYSTEM	ESFR
SLAB	8" Reinforced Concrete, 4,000 PSW w/ Full Vapor Barrier
POWER	3 Phase - Finish to Suit
ROOF & INSULATION	TPO with R9
SECURITY	Ability to Fully Secure with Fence/Guard Shack
SPEC FINISH OUT	White Box, Painted Columns, LED Wall Packs, Pole Lights

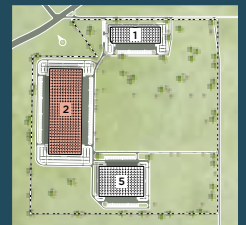

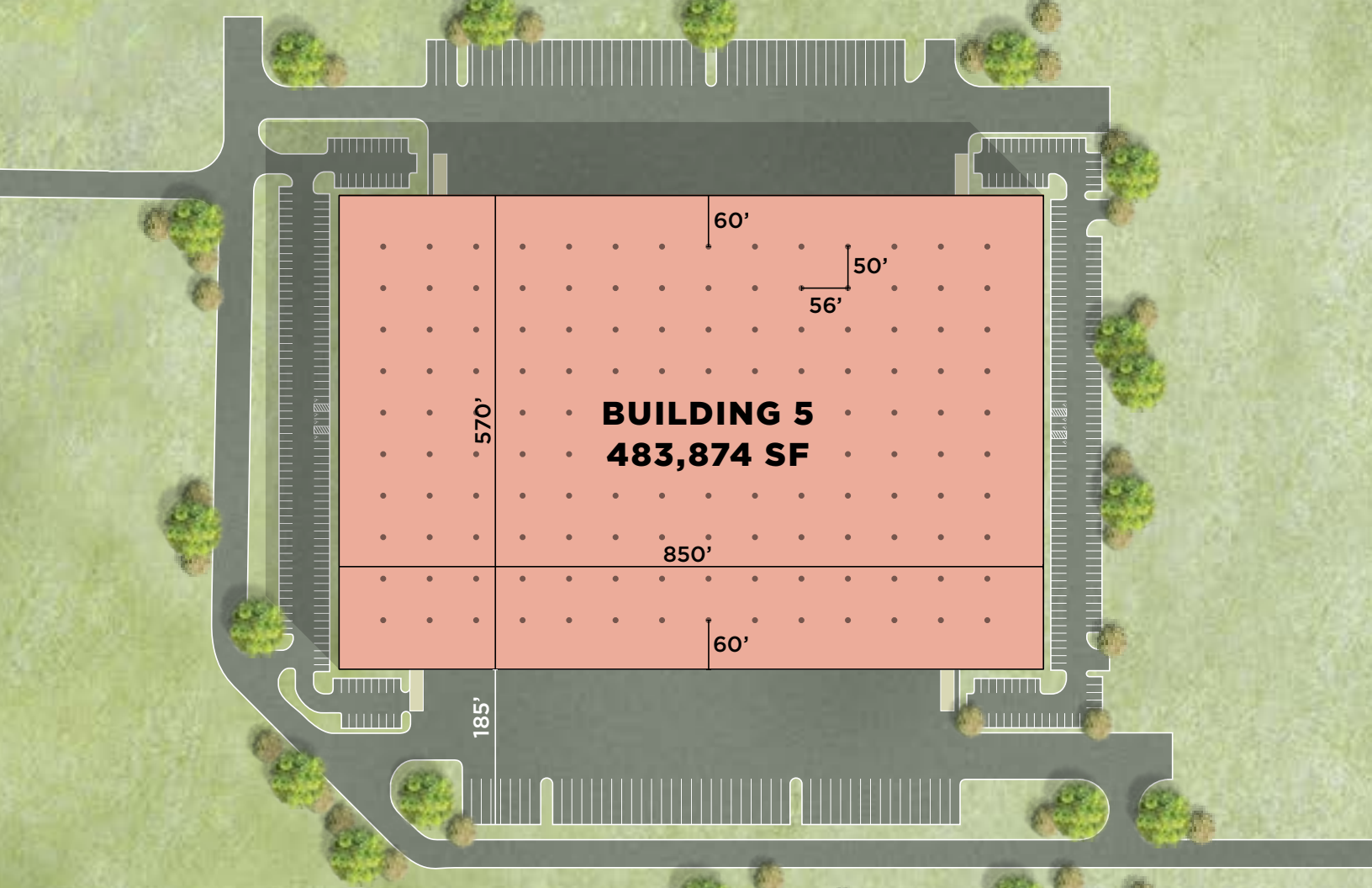

# Building 5

**483,874 SF**

size (expandable)

## Build-to-Suit

office

**570' x 850'**

dimensions

**40'**

clear height

TYP. COLUMN SPACING	56' w x 50' d
STAGING BAY	60'
TRUCK COURT DEPTH	185'
DOCK DOORS	74 (9' x 10')
DRIVE-IN RAMPS	4 (12' x 14')
TRAILER PARKS	94
CAR PARKS	330
SPRINKLER SYSTEM	ESFR
SLAB	7" Reinforced Concrete, 4,000 PSW w/ Full Vapor Barrier
POWER	3 Phase - Finish to Suit
ROOF & INSULATION	TPO with R9
SECURITY	Ability to Fully Secure with Fence/Guard Shack
SPEC FINISH OUT	White Box, Painted Columns, LED Wall Packs, Pole Lights

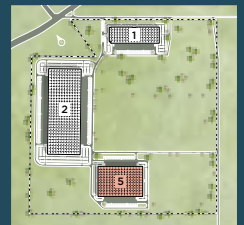

Interstate 635

10.8 miles 14 minutes

Interstate 30

21.6 miles 19 minutes

Interstate 45

17.4 miles 17 minutes

Dallas CBD

27.2 miles 26 minutes

DFW Int'l Airport

47.8 miles 41 minutes

Dallas Love Field Airport

33.5 miles 34 minutes

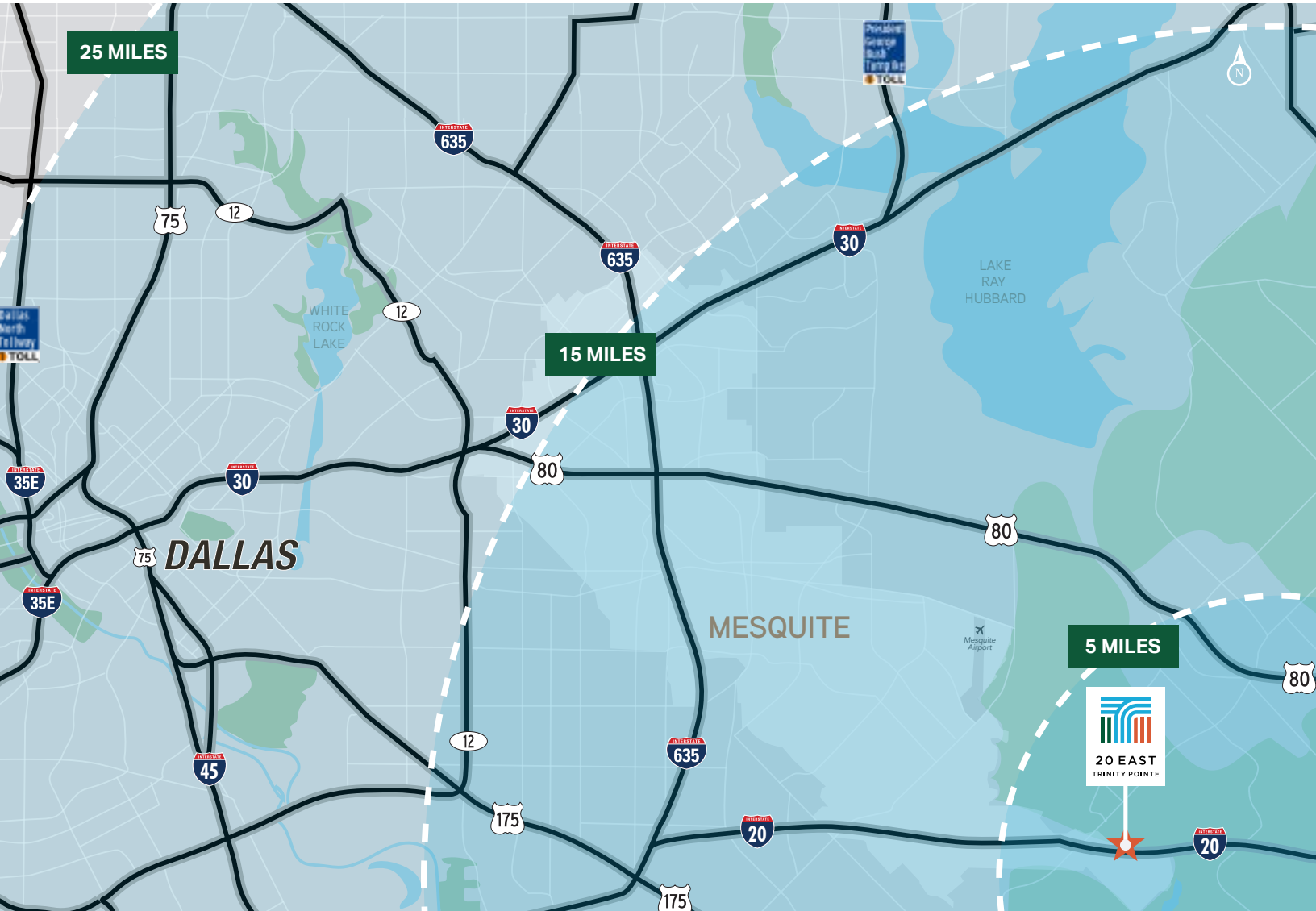

**MATT DORNAK, SIOR** | 214.267.0461 | mdornak@streamrealty.com

**RIDLEY CULP** | 214.560.2422 | ridley.culp@streamrealty.com

OWNED & DEVELOPED BY:





# 20 EAST

## TRINITY POINTE

**MATT DORNAK, SIOR** | 214.267.0461 | [mdornak@streamrealty.com](mailto:mdornak@streamrealty.com)

**RIDLEY CULP** | 214.560.2422 | [ridley.culp@streamrealty.com](mailto:ridley.culp@streamrealty.com)

OWNED & DEVELOPED BY:

